

SURVEYOR'S OFFICE

# Hamilton County

*Kenton C. Ward, Surveyor*  
 Phone (317) 776-8495  
 Fax (317) 776-9628

*Suite 188*  
*One Hamilton County Square*  
*Noblesville, Indiana 46060-2230*

August 22, 2005

**TO: Hamilton County Drainage Board**

**RE: Harmon Clark Drain, Kensington Carriage Homes at Oak Trace Arm**

Attached is a petition filed by C and R Custom Homes along with a non-enforcement request, plans, calculations, quantity summary and assessment roll for the Kensington Carriage Homes at Oak Trace Arm, Harmon Clark Drain to be located in Washington Township. I have reviewed the submittals and petition and have found each to be in proper form.

I have made a personal inspection of the land described in the petition. Upon doing so, I believe that the drain is practicable, will improve the public health, benefit a public highway, and be of public utility and that the costs, damages and expenses of the proposed drain will probably be less than the benefits accruing to the owners of land likely to be benefited. The drain will consist of the following:

12" RCP	823 feet	18" RCP	135 feet	24" RCP	363 feet
15" RCP	719 feet	21" RCP	775 feet	30" RCP	827 feet

The total length of the drain will be 3,642 feet.

The retention pond (lake) located in the Common Area is to be considered part of the regulated drain. Pond maintenance shall include the inlet and outlet, sediment removal and erosion control along the banks as part of the regulated drain. The maintenance of the pond, such as mowing and aquatic vegetation control will be the responsibility of the Homeowners Association. The Board will however retain jurisdiction for ensuring the storage volume for which the lake was designed will be retained. Thereby, allowing no fill or easement encroachments.

I have reviewed the plans and believe the drain will benefit each lot equally. Therefore, I recommend each lot be assessed equally. I also believe that no damages will result to landowners by the construction of this drain. I recommend a maintenance assessment of \$15.00 per acre for common areas and platted lots, with a \$50.00 minimum, \$10.00 per acre for roadways. With this assessment the total annual assessment for this drain/this section will be \$4,596.30.

The petitioner has submitted surety for the proposed drain at this time. The sureties which are in the form of a Performance Bond are as follows:

Agent: Bond Safeguard Insurance Company  
Date: March 28, 2005  
Number: 5014592  
For: Storm Sewers  
Amount: \$206,202.00

Agent: Bond Safeguard Insurance Company  
Date: March 28, 2005  
Number: 5014594  
For: Erosion Control  
Amount: \$11,428.80

Parcels assessed for this drain may be assessed for the H.G. Kenyon or Cool Creek Drain at sometime in the future.

I believe this proposed drain meets the requirements for Urban Drain Classification as set out in IC 36-9-27-67 to 69. Therefore, this drain shall be designated as an Urban Drain.

The offsite outlet pipe will run through Lot 6 of South Oak Industrial Park, parcel number 09-09-12-00-00-002.101, which is owned by Sandra L. Gooding. The pipe will intersect the open ditch at the east property line of the Gooding Parcel, which is approximately Sta. 3+40 of the open ditch between Str. 717 and the detention pond for South Oak Industrial Park. The offsite pipe will be located in a Utility Easement recorded in the office of the Hamilton County Recorder as instrument #200100032168.

I recommend that upon approval of the above proposed drain that the Board also approve the attached non-enforcement request. The request is for the reduction of the regulated drain easement to those easement widths as shown on the secondary plat for Kensington Carriage Homes at Oak Trace as recorded in the office of the Hamilton County Recorder.

I recommend the Board set a hearing for this proposed drain for January 23, 2006.

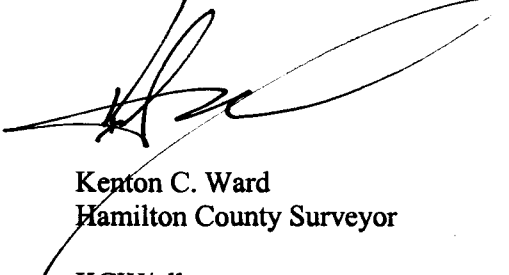

Kenton C. Ward  
Hamilton County Surveyor

KCW/pll

STATE OF INDIANA        )  
                                  )  
COUNTY OF HAMILTON    )

(Revised 06/08/04)

TO: HAMILTON COUNTY DRAINAGE BOARD  
c/o Hamilton County Surveyor  
One Hamilton County Square, Suite 188  
Noblesville, IN 46060-2230

In the matter of **Kensington Carriage Homes at Oak Trace** Subdivision, Section  
**Harmon Clark regulated** Drain Petition.

Petitioner is the owner of all lots in the land affected by the proposed new regulated drain. The drainage will affect various lots in **Kensington Carriage Homes at Oak Trace**, a subdivision in Hamilton County, Indiana. The general route of such drainage shall be in existing easements and along public roads as shown in the plans on file in the Surveyor's Office.

Petitioner believes that the cost, damages and expenses of the proposed improvement will be less than the benefits, which will result to the owners of the land likely to be benefited thereby. Petitioner believes the proposed improvements will:

- (a) improve public health
- (b) benefit a public street
- (c) be of public utility

Petitioner agrees to pay the cost of construction of the drainage system and requests periodic maintenance assessments by the Board thereafter.

The Petitioner also agrees to the following:

1. To provide the Drainage Board a Performance Bond or Non-Revocable Letter of Credit for the portion of the drainage system which will be made a regulated drain. The bond will be in the amount of 120% of the Engineer's estimate. The bond will be in effect until construction of 100% of the system is completed and so certified by the Engineer.
2. The Petitioner shall retain an Engineer throughout the construction phase. At completion of the project the Petitioner's Engineer shall certify that the drainage system which is to be maintained as a regulated drain has been constructed as per construction plans.
3. The Petitioner agrees to request in writing to the County Surveyor any changes from the approved plan and must receive written authorization from the County Surveyor prior to implementation of the change. All changes shall be documented and given to the Surveyor to be placed in the Drain file.
4. The Petitioner shall instruct his Engineer to provide a reproducible print on a 24" x 36" Mylar of the final design of the Drainage System. This shall be submitted to the County Surveyor prior to the release of the Performance Bond.
5. The Petitioner shall comply with the Erosion Control Plan as specified on the construction plans. Failure to comply with the Erosion Control Plan shall be determined by the Board as being an obstruction to the drainage system. The County Surveyor shall immediately install or repair the needed measures at Petitioners cost as per IC-36-9-27-46.

The Petitioner further requests that the Drain be classified as an Urban Drain as per IC 36-9-27-69(d).

**RECORDED OWNER(S) OF LAND INVOLVED**

  
Signed

**Larry Cowell**  
Printed Name

11.16.04  
Date

\_\_\_\_\_  
Signed

\_\_\_\_\_  
Printed Name

\_\_\_\_\_  
Date

\_\_\_\_\_  
Signed

\_\_\_\_\_  
Printed Name

\_\_\_\_\_  
Date

\_\_\_\_\_  
Signed

\_\_\_\_\_  
Printed Name

\_\_\_\_\_  
Date

FINDINGS AND ORDER

CONCERNING THE MAINTENANCE OF THE

Harmon Clark Drain, Kensington Carriage Homes at Oak Trace Arm

On this **23rd day of January 2006**, the Hamilton County Drainage Board has held a hearing on the Maintenance Report and Schedule of Assessments of the **Harmon Clark Drain, Kensington Carriage Homes at Oak Trace**.

Evidence has been heard. Objections were presented and considered. The Board then adopted the original/amended Schedule of Assessments. The Board now finds that the annual maintenance assessment will be less than the benefits to the landowners and issues this order declaring that this Maintenance Fund be established.

HAMILTON COUNTY DRAINAGE BOARD

  
\_\_\_\_\_  
President

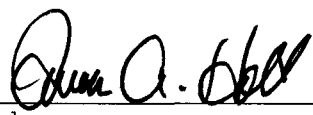
  
\_\_\_\_\_  
Member

  
\_\_\_\_\_  
Member

Attest: 

FINDINGS AND ORDER

CONCERNING THE PARTIAL VACATION OF THE

**Harmon Clark Drain**  
**Original Southoak Industrial Park Arm - Str. 717 to Str. 925**  
**Kensington Carriage Homes at Oak Trace Arm - 49' of 21" RCP**

On this *22nd day of January 2007*, the Hamilton County Drainage Board has held a hearing on the Maintenance Report and Schedule of Assessments of the **Harmon Clark Drain: Str. 717 to Str. 925 of Original Southoak Industrial Park Arm; and 49' of 21" RCP of Kensington Carriage Homes at Oak Trace Arm.**

Evidence has been heard. Objections were presented and considered. The Board then adopted an order of action. The Board now finds that the costs of continued maintenance to the portion of the above drain exceed the benefits to the real estate benefited by the portion of the drain to be abandoned and issues this order vacating the above section of the **Harmon Clark Drain.**

HAMILTON COUNTY DRAINAGE BOARD



President



Member

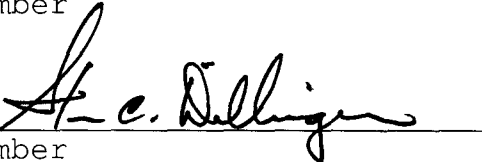

Member

Attest: 

CERTIFICATE OF COMPLETION AND COMPLIANCE

To: Hamilton County Surveyor

Re: Kensington Carriage Homes at Oak Trace

I hereby certify that:

1. I am a Registered Land Surveyor or Engineer in the State of Indiana.
2. I am familiar with the plans and specifications for the above referenced subdivision.
3. I have personally observed and supervised the completion of the drainage facilities for the above referenced subdivision.
4. The drainage facilities within the above referenced subdivision to the best of my knowledge, information and belief have been installed and completed in conformity with all plans and specifications.
5. The drainage facilities within the above referenced subdivision to the best of my knowledge, information and belief have been correctly represented on the Record Drawings, Digital Record Drawings and the Structure Data Spreadsheet.

Signature: James K. Shineman Date: 12/9/05

Type or Print Name: James K. Shineman

Business Address: 10505 N. College Ave  
Indianapolis, IN 46280

Telephone Number: (317) 846-6611

SEAL

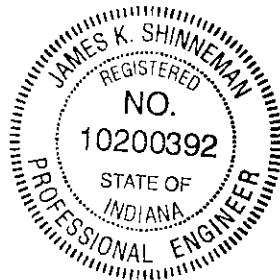

INDIANA REGISTRATION NUMBER

10200392

KCW

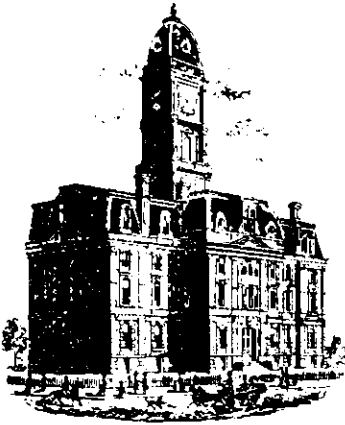

# SURVEYOR'S OFFICE Hamilton County

Kenton C. Ward, CFM  
Surveyor of Hamilton County  
Phone (317) 776-8495  
Fax (317) 776-9628

Suite 188  
One Hamilton County Square  
Noblesville, Indiana 46060-2230

To: Hamilton County Drainage Board

March 20, 2009

Re: Harmon Clark Drain: Kensington Carriage at Oak Trace Arm

Attached are as-builts, certificate of completion & compliance, and other information for Kensington Carriage at Oak Trace Arm. An inspection of the drainage facilities for this section has been made and the facilities were found to be complete and acceptable.

During construction, changes were made to the drain, which will alter the plans submitted with my report for this drain-dated August 22, 2005. The report was approved by the Board at the hearing held January 23, 2006. (See Drainage Board Minutes Book 9, Pages 42-43) The changes are as follows:

Structure:	Length:	Size	Material:	Up Invert:	Dn Invert	Grade:	Changes:
202-201	400	21	RCP	886.9	884.18	0.27	
201-200	22	12	RCP	887	887	0	
203-202	74	21	RCP	887	886.9	0.14	
201-200	89	21	RCP	885.83	885.78	0.06	-36
208-207	61	12	RCP	887.28	886.94	0.56	
217-216	58	12	RCP	894.79	893.03	1.48	
216-215	112	15	RCP	893.77	893.24	0.47	
215-214	138	30	RCP	891.84	891.58	0.19	
214-213	153	30	RCP	891.58	891.21	0.24	
213-212	116	30	RCP	891.21	890.7	0.44	
212-211	133	30	RCP	890.7	890.46	0.18	
211-210	147	30	RCP	890.46	889.84	0.42	
210-209	44	30	RCP	889.04	886.99	4.66	
218-213	54	12	RCP	893.14	891.21	1.94	
220-219	103	12	RCP	894.33	893.99	0.33	
219-214	113	12	RCP	893.99	893.11	0.78	
221-216	223	15	RCP	894.43	893.93	0.3	
231-223	67	12	RCP	895.68	894.45	1.84	
223-222	212	15	RCP	894.45	892.8	0.78	
222-215	96	30	RCP	892.22	893.24	0.4	



227-226	158	12	RCP	896	894.45	0.98	
226-225	176	21	RCP	893.8	893.42	0.21	
225-224	239	24	RCP	893.1	892.34	0.32	
224-222	124	24	RCP	892.34	892.25	0.07	
229-228	172	15	RCP	895.26	894.38	0.51	
228-226	135	18	RCP	894.38	893.79	0.44	
230-224	185	12	RCP	894.77	893.34	0.77	

**RCP Pipe Totals:**

12	821
15	719
18	135
21	739
24	363
30	827

The length of the drain due to the changes described above is now **3604 feet**.

Note: Structure 201-200 was shortened due to the instillation of the Southoak Industrial Park Extension.

The non-enforcement was approved by the Board at its meeting on January 23, 2006 and recorded under instrument #200600004923.

The following sureties were guaranteed by Bond Safeguard Insurance Company and released by the Board on its March 28, 2005 meeting.

**Bond-LC No:** 5014592  
**Insured For:** Storm Sewers  
**Amount:** \$206,202.00  
**Issue Date:** March 28, 2005

**Bond-LC No:** 5014594  
**Insured For:** Erosion Control  
**Amount:** \$11,428.80  
**Issue Date:** March 28, 2005

I recommend the Board approve the drain's construction as complete and acceptable.

Sincerely,

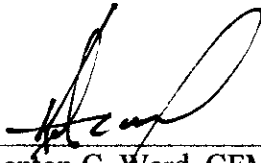

\_\_\_\_\_  
Kenton C. Ward, CFM  
Hamilton County Surveyor

KCW/slm

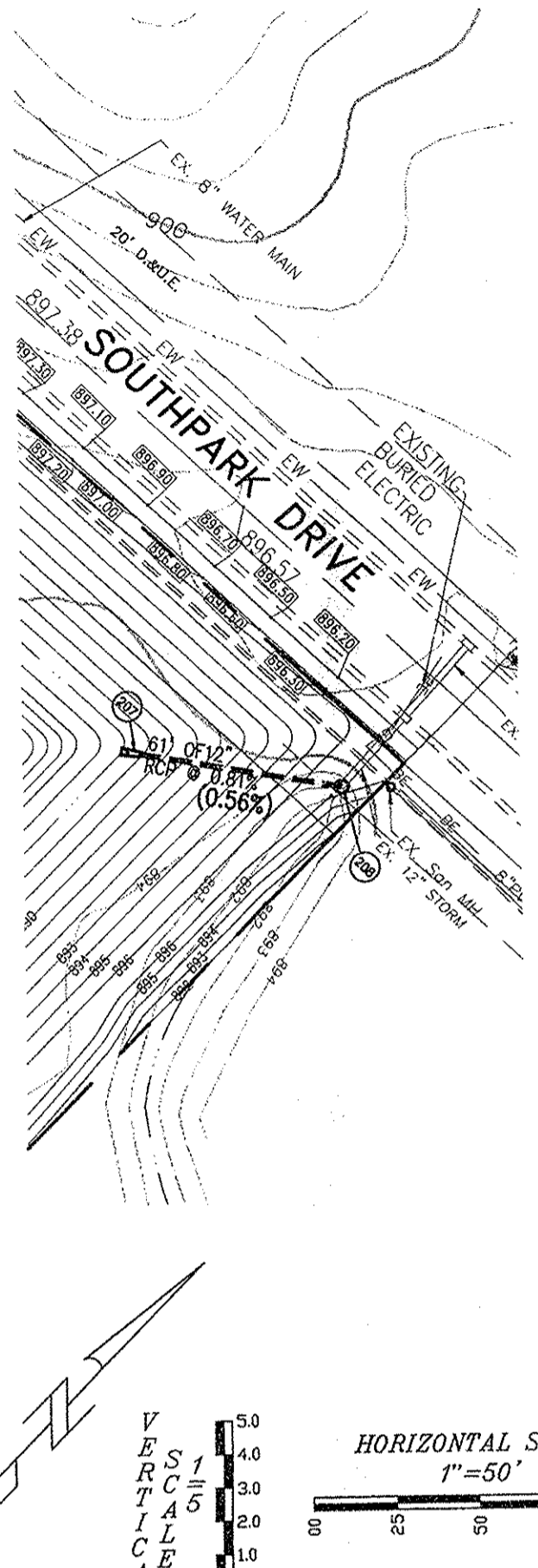

**NOTE:**

- STORM SEWERS MUST MEET HAMILTON COUNTY SURVEYORS OFFICE CURRENT DETAILS AND SPECIFICATIONS.
- ALL CASTINGS MUST BE STAMPED WITH "DUMP NO WASTE DRAINS TO WATERWAY"

**RECORD DRAWING**  
STORM SEWER AS-BUILTS  
STORM SEWER STRUCTURES ONLY  
12-09-05

*James K. Shinneman*  
JAMES K. SHINNEMAN P.E. 10200392

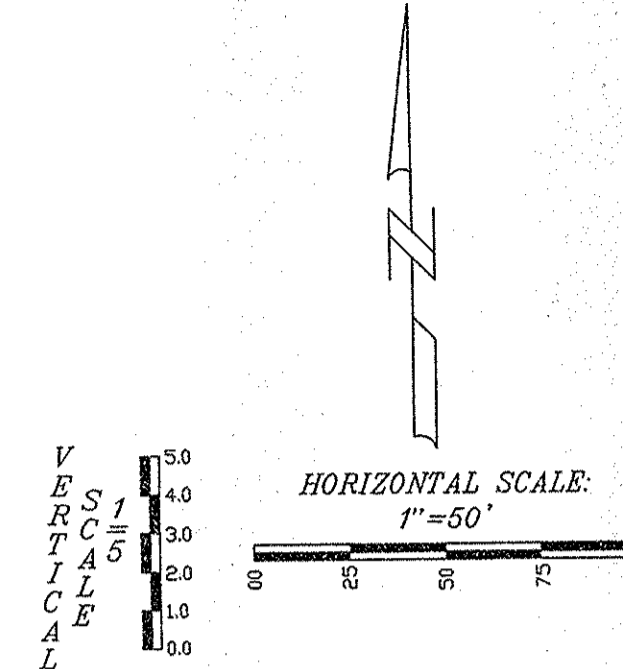

- LEGEND**
- RIGHT-OF-WAY LINE
  - STORM SEWER LINE
  - SWALE
  - SANITARY SEWER LINE
  - SANITARY SEWER MANHOLE
  - SANITARY SEWER LATERAL
  - FLOW DIRECTION
  - 992.57 EXISTING SPOT ELEVATION
  - EXISTING CONTOURS
  - PROPOSED ELEVATION
  - o STORM MANHOLE
  - o STORM INLET
  - T.C. TOP OF CASTING
  - INV. INVERT
  - RCP REINFORCED CONCRETE PIPE
  - M.H. MANHOLE
  - STR. STRUCTURE
  - D. & U.E. DRAINAGE AND UTILITY EASEMENT
  - S.D. & U.E. SANITARY, DRAINAGE, AND UTILITY EASEMENT
  - S & U.E. SANITARY AND UTILITY EASEMENT
  - H.C. HANDICAP RAMP
  - M.E. MATCH EXISTING GRADE
  - S.S.P. SUBSURFACE DRAIN AND SUMP LINE
  - STM STORM SEWER
  - GRANULAR BACKFILL
  - CONCRETE END SECTION
  - S.S.D. SUBSURFACE DRAIN
  - S.S.P. SANITARY SEWER PIPE (SDR-35)
  - TYP. TYPICAL
  - PROP. PROPOSED
  - EX. EXISTING
  - R. RADIUS
  - I & E SMIT INGRESS/EGRESS EASEMENT

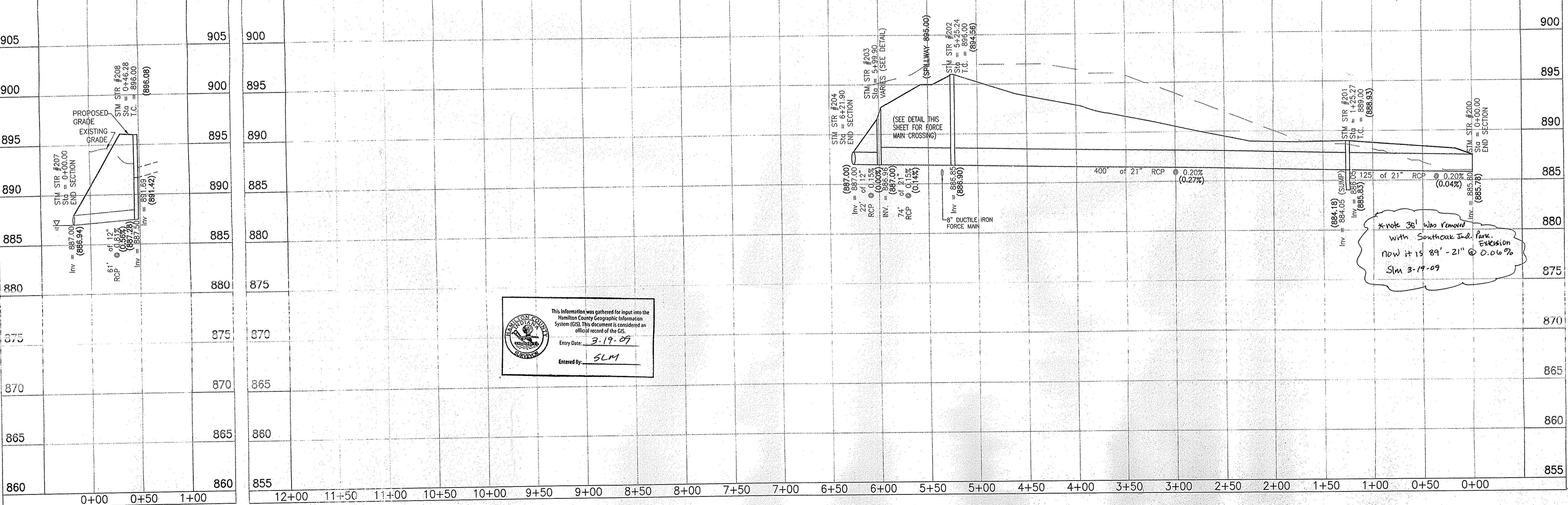
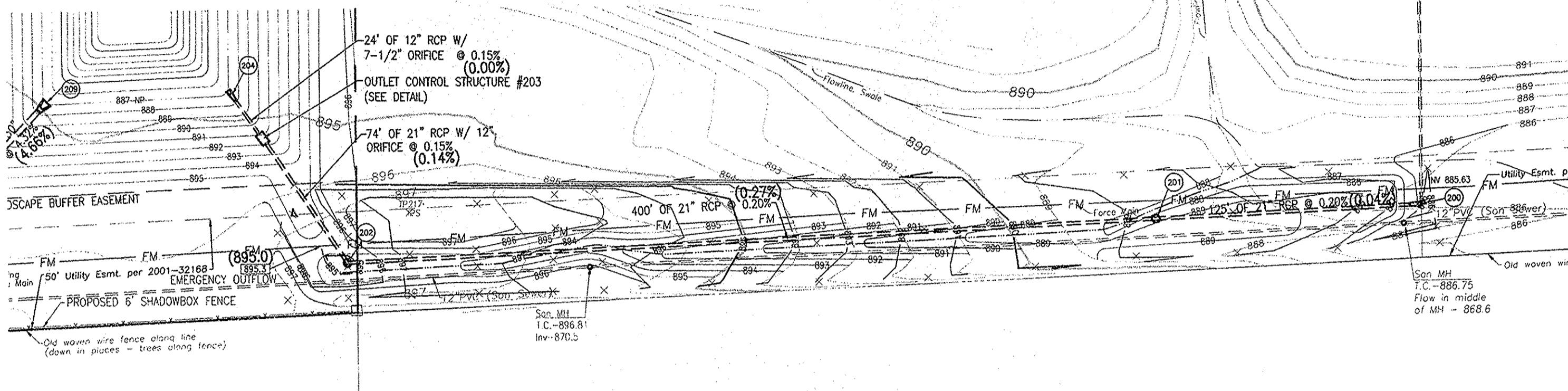
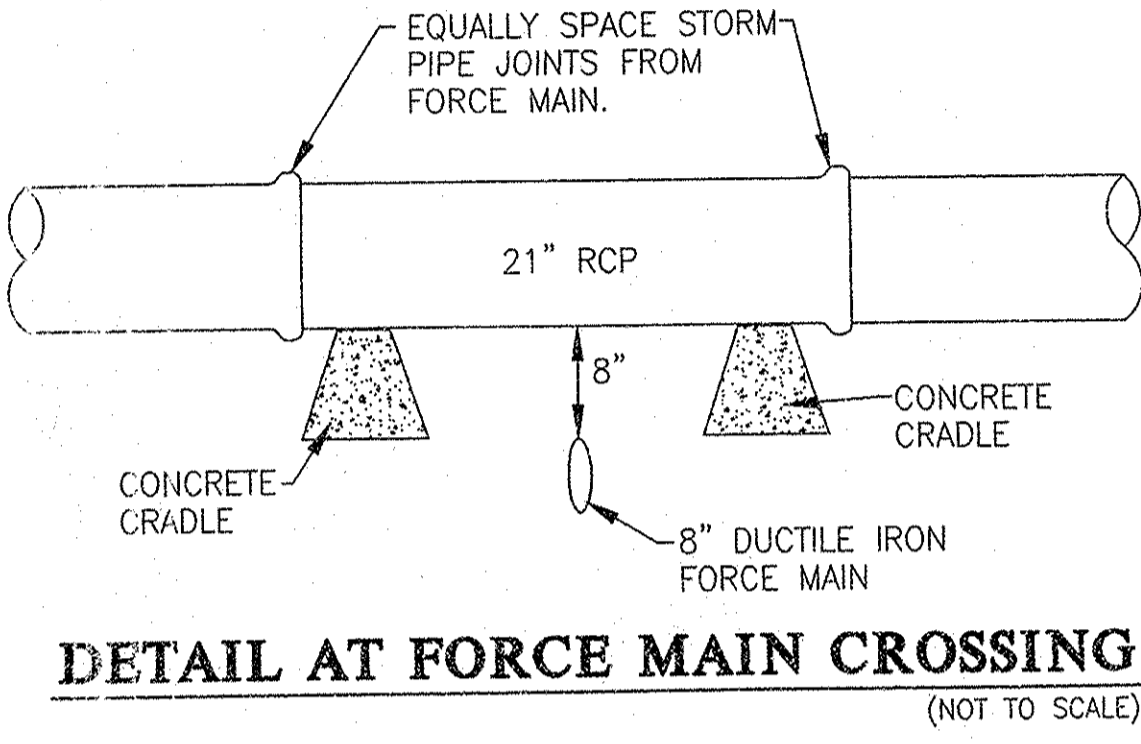

This information was gathered for input into the Hamilton County Geographic Information System (GIS). This document is considered an official record of the GIS.

Entry Date: 3-19-09  
Entered By: SLM

**WEIHE ENGINEERS, INC.**  
10505 NORTH COLLEGE AVENUE  
INDIANAPOLIS, INDIANA 46280  
(317) 846-6611 FAX: (317) 843-0546  
TOLL-FREE (800) 852-6408

ALLAN H. WEIHE  
REGISTERED LAND SURVEYOR  
REGISTERED LAND SURVEYOR PRESIDENT

CIVIL ENGINEERS • LAND SURVEYORS • LAND PLANNERS • LANDSCAPE ARCHITECTS

PROJECT NO.:	W04-0531
DATE:	10/13/04
DESIGNED BY:	JAS/MS
DRAWN BY:	JAS/MS
CHECKED BY:	JAS/MS
DATE:	10/13/04

JAMES K. SHINNEMAN  
REGISTERED  
NO. 10200392  
STATE OF INDIANA  
PROFESSIONAL ENGINEER

*James K. Shinneman*  
12-19-05  
JAMES K. SHINNEMAN P.E. 10200392

PREPARED FOR:  
**Kensington Carriage Homes at Oak Trace**  
C & R CUSTOM HOMES

STORM SEWER PLAN AND PROFILE  
Part of the 1/4 of Section 12, Township 18 North, Range 2 East, 2nd Meridian, Hamilton County, Indiana

SHEET NO. **6**

PROJECT NO.  
W04-0531

DATE PLOTTED: 12/21/05 10:07:11 AM  
PLOT FILE: C:\PROJECTS\W040531\PLT\W040531.PLT  
PLOT NUMBER: 04  
PLOT SCALE: 1:1

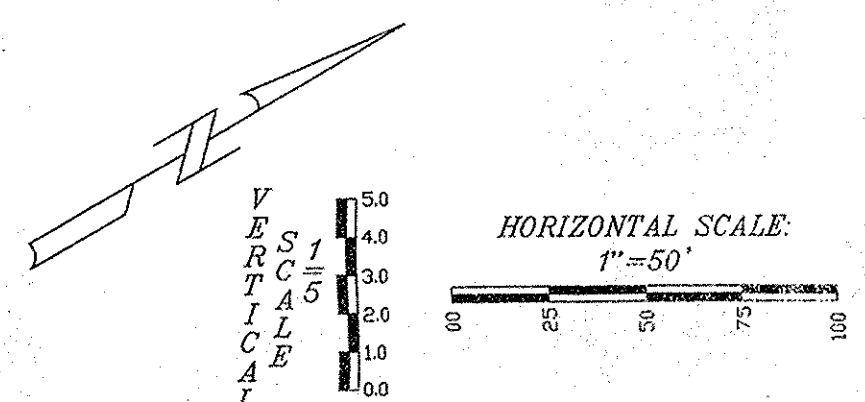
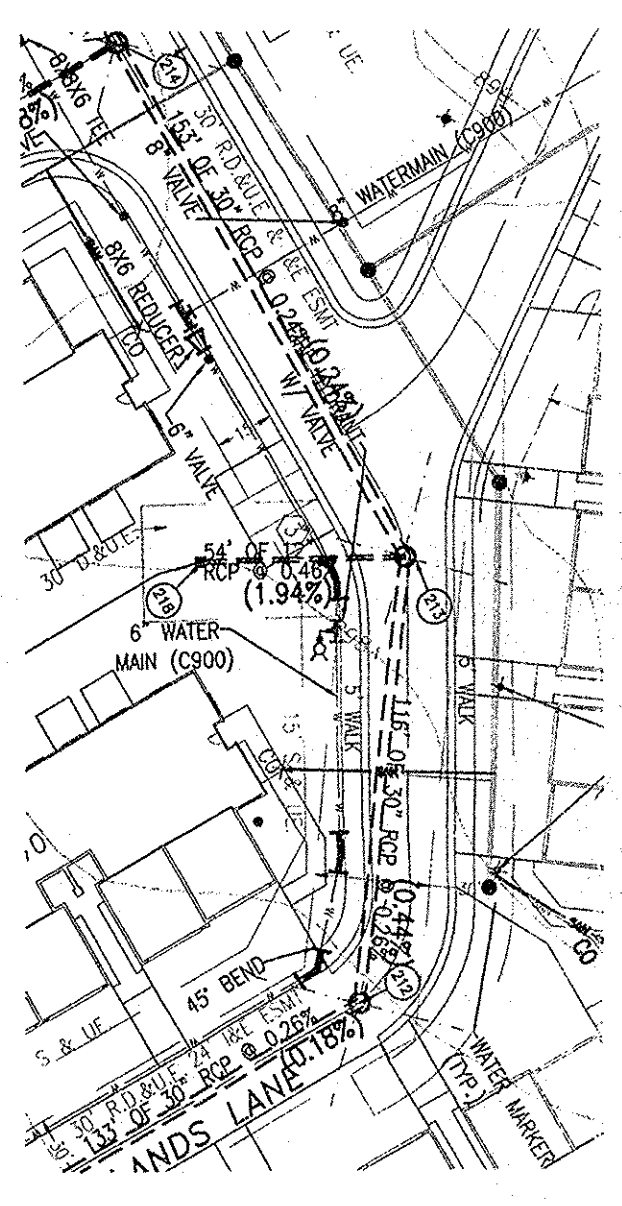

HORIZONTAL SCALE:  
1" = 50'

---	RIGHT-OF-WAY LINE
---	STORM SEWER LINE
---	SWALE
---	SANITARY SEWER LINE
---	SANITARY SEWER MANHOLE
---	SANITARY SEWER LATERAL
---	FLOW DIRECTION
o	EXISTING SPOT ELEVATION
o	EXISTING CONTOURS
o	PROPOSED ELEVATION
o	STORM MANHOLE
o	STORM INLET
o	TOP OF CASTING
o	INVERT
o	REINFORCED CONCRETE PIPE
o	MANHOLE
o	STRUCTURE
D. & U.E.	DRAINAGE AND UTILITY EASEMENT
S.D. & U.E.	SANITARY, DRAINAGE, AND UTILITY EASEMENT
S & U.E.	SANITARY AND UTILITY EASEMENT
SAN	SANITARY SEWER
H.C.P.	HANDICAP RAMP
M.E.P.	MATCH EXISTING GRADE
---	SUBSURFACE DRAIN AND SUMP LINE
---	STORM SEWER
---	GRANULAR BACKFILL
---	CONCRETE END SECTION
S.S.D.	SUBSURFACE DRAIN
S.S.P.	SANITARY SEWER PIPE (SDR-35)
TYP.	TYPICAL
PROP.	PROPOSED
EX.	EXISTING
R.	RADIUS
I & E ESMT	INGRESS/EGRESS EASEMENT

**NOTE:**

- STORM SEWERS MUST MEET HAMILTON COUNTY SURVEYORS OFFICE CURRENT DETAILS AND SPECIFICATIONS.
- ALL CASTINGS MUST BE STAMPED WITH "DUMP NO WASTE DRAINS TO WATERWAY"

**RECORD DRAWING**  
STORM SEWER AS-BUILTS  
STORM SEWER STRUCTURES ONLY  
12-09-05

*James K. Shinneman*  
JAMES K. SHINNEMAN P.E. 10200392

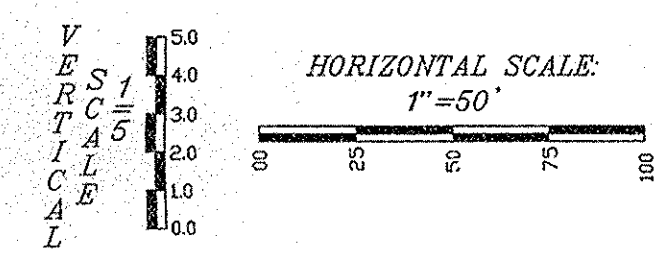

(XXX.XX) = ASBUILT ELEVATION

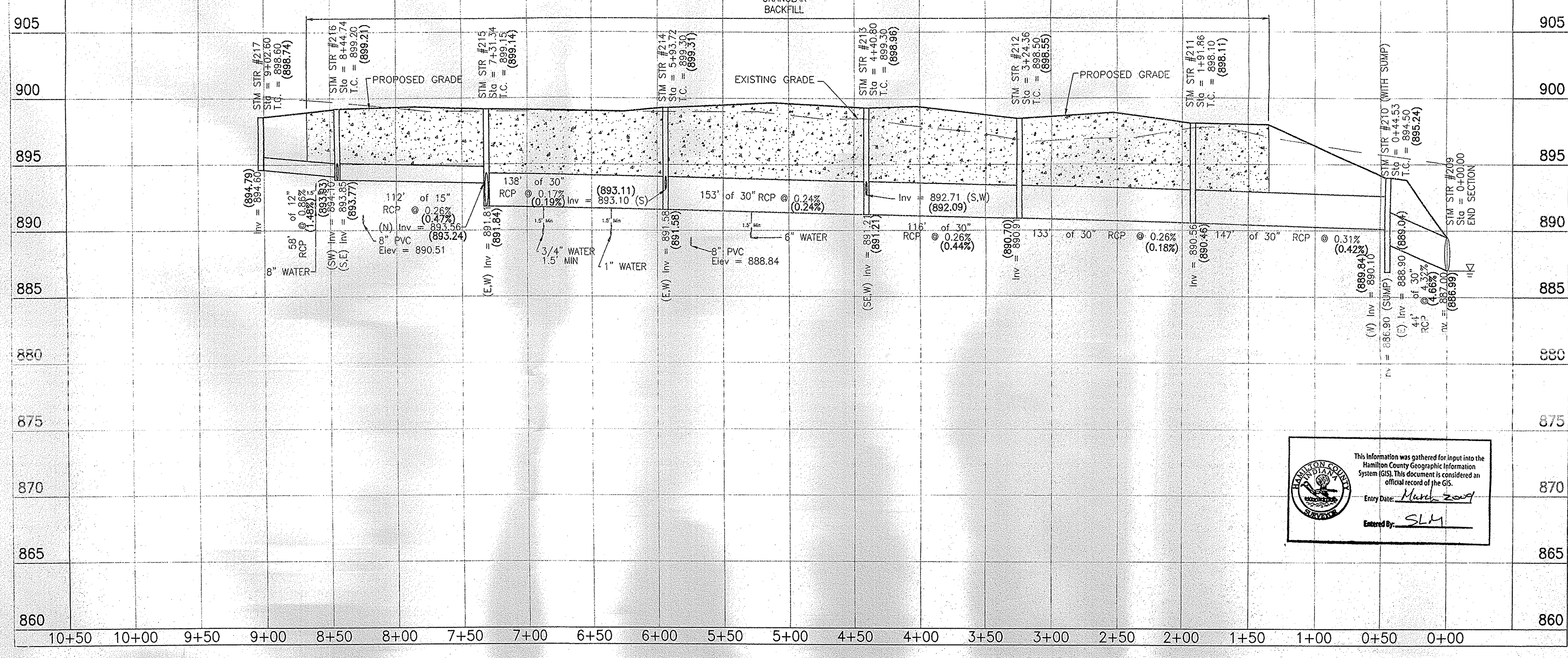
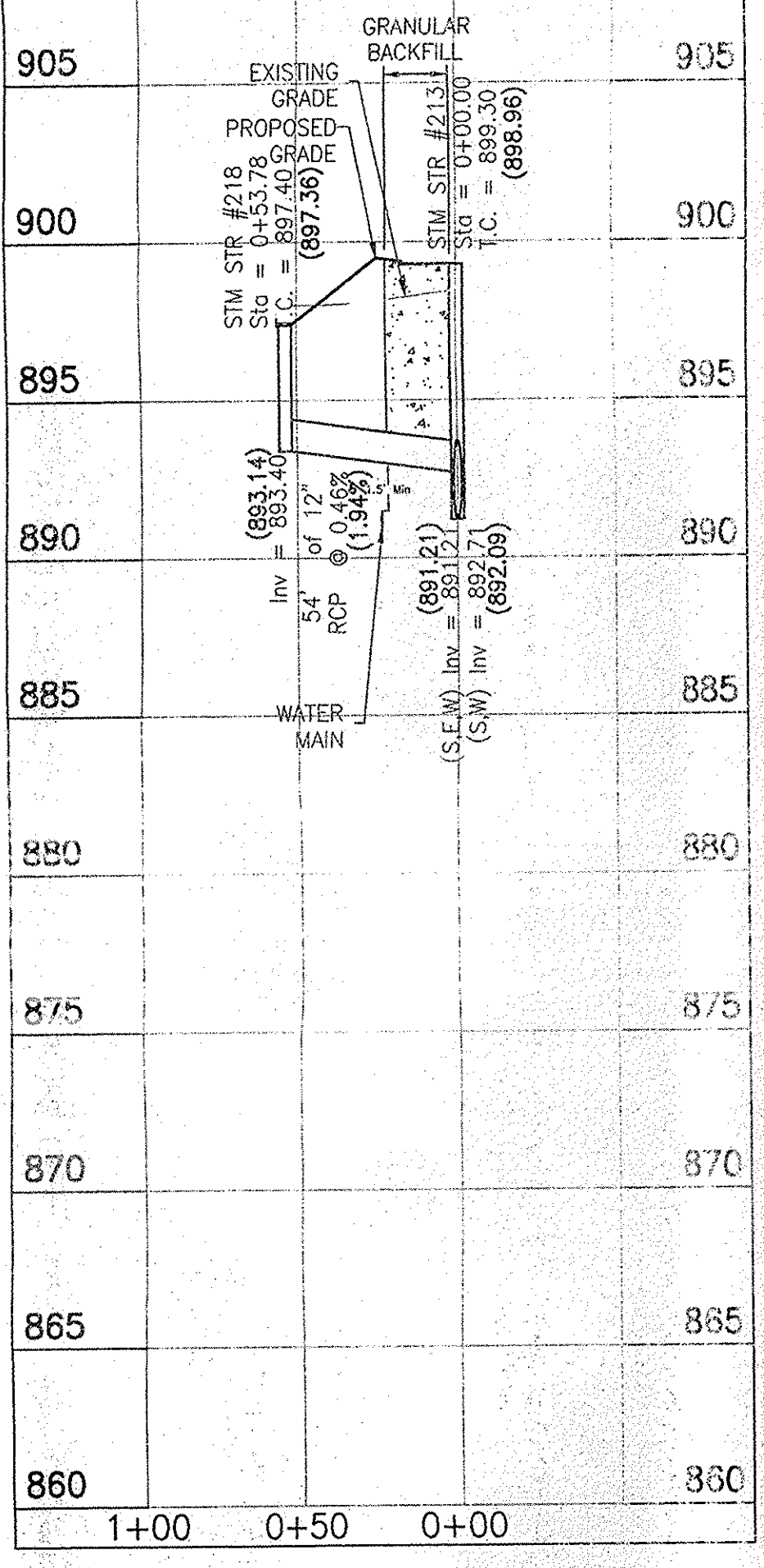

This information was gathered for input into the Hamilton County Geographic Information System (GIS). This document is considered an official record of the GIS.  
Entry Date: March 2007  
Entered By: SLM

**WEIHE ENGINEERS, INC.**

1858 NORTH COLLEGE AVENUE  
INDIANAPOLIS, INDIANA 46202  
(317) 846-6611 FAX: (317) 843-0546  
TOLL-FREE (800) 452-6408

ALLAN H. WEIHE  
REGISTERED LAND SURVEYOR  
REGISTERED PROFESSIONAL ENGINEER

CIVIL ENGINEERS • LAND SURVEYORS • LAND PLANNERS • LANDSCAPE ARCHITECTS

PROJECT NO. 04-03	DATE 11/20/05	BY JAB
DATE 11/20/04	DATE 12/09/05	BY JAB
DESIGNED BY: EAC/JNS	CHECKED BY: JKS	DRAWN BY: JKS
DATE 1/20/05	DATE 6/27/05	DATE 12/09/05
BY JAB	BY JAB	BY JAB
BY JAB	BY JAB	BY JAB

REVISIONS AND ISSUES:  
REVISIONS FOR FIELD REVIEW  
REVISIONS TO GRADING AND LANDSCAPE PER HAMILTON COUNTY SURVEYORS OFFICE  
REVISIONS TO GRADING  
REVISIONS TO WATER MAIN  
REVISIONS TO STORM, SANITARY AND WATER ASBUILTS

**JAMES K. SHINNEMAN**  
REGISTERED PROFESSIONAL ENGINEER  
NO. 10200392  
STATE OF INDIANA

*James K. Shinneman*  
JAMES K. SHINNEMAN P.E. 10200392

PREPARED FOR:  
*Kensington Carriage Homes at Oak Trace*

C & R CUSTOM HOMES  
**STORM SEWER PLAN AND PROFILE**  
Part of the I/I of Station 12, Parades 13, North, Range 2, East, Township of Shelby, Hamilton County, Indiana, 2005.

SHEET NO. **7**

PROJECT NO. **W04-0531**

LOCATION: H:\004\W040531\VIEW\CONSET\W040531STV.dwg  
DATE/TIME: December 20, 2005 - 10:10am  
PLOTED BY: coffee

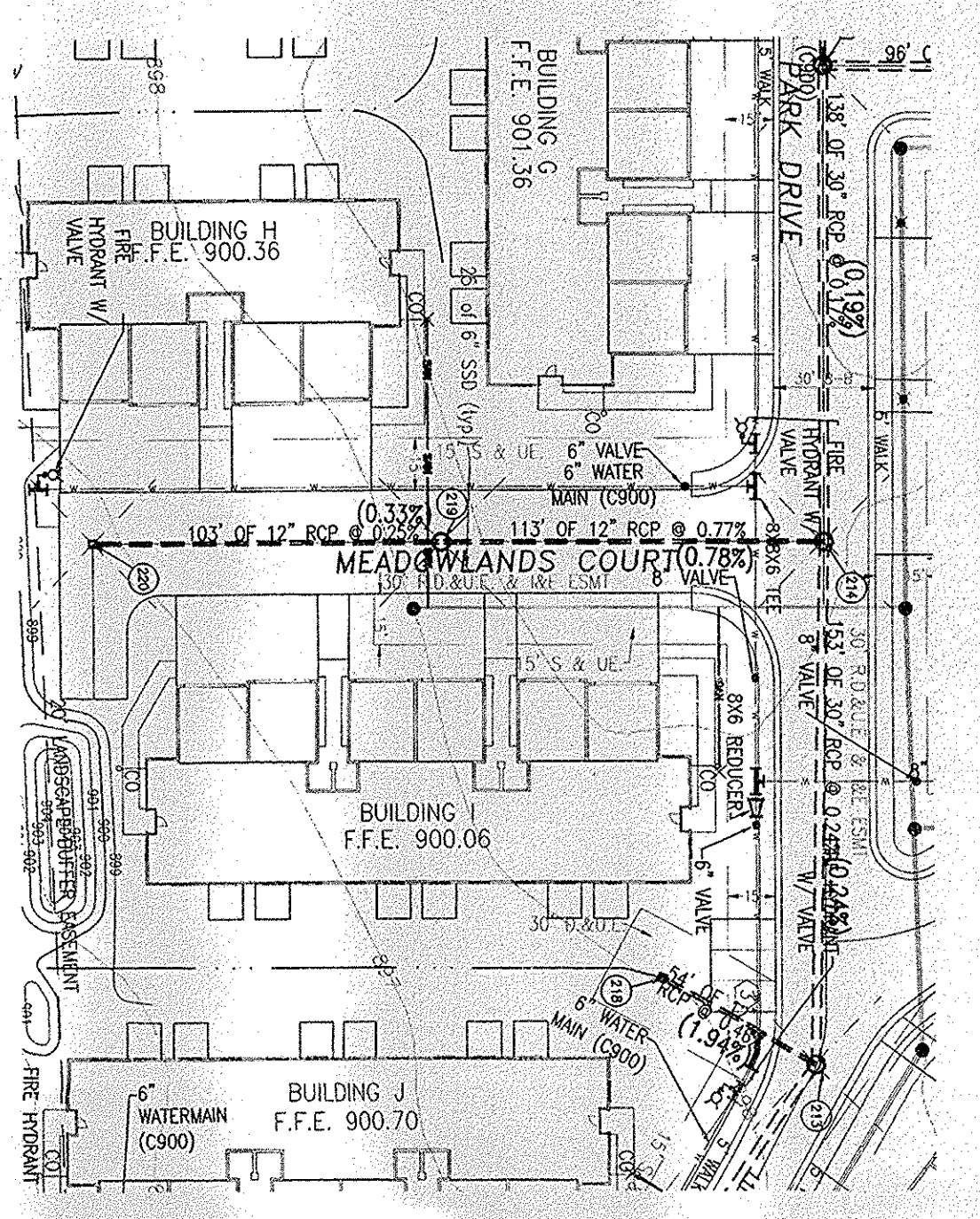
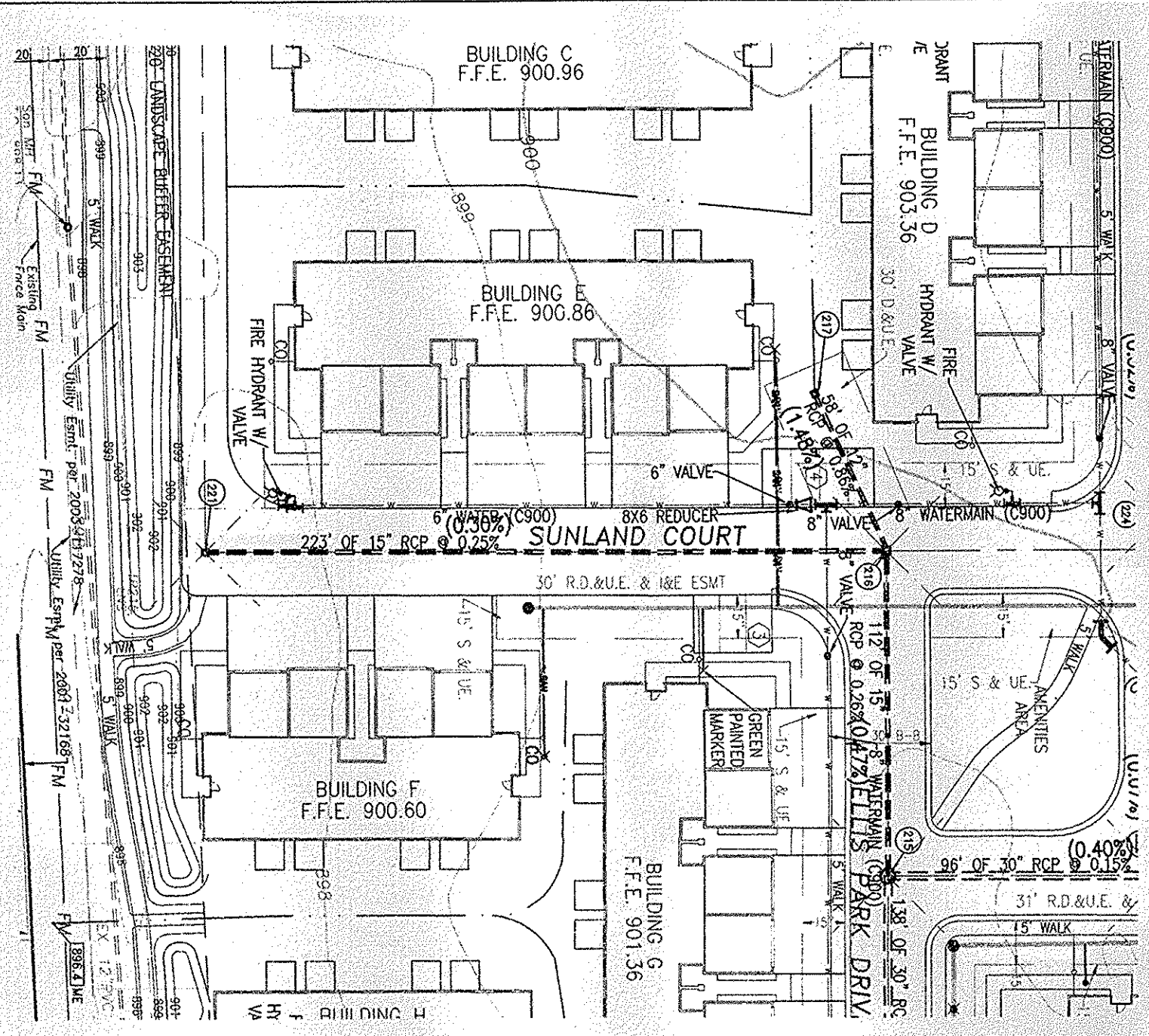
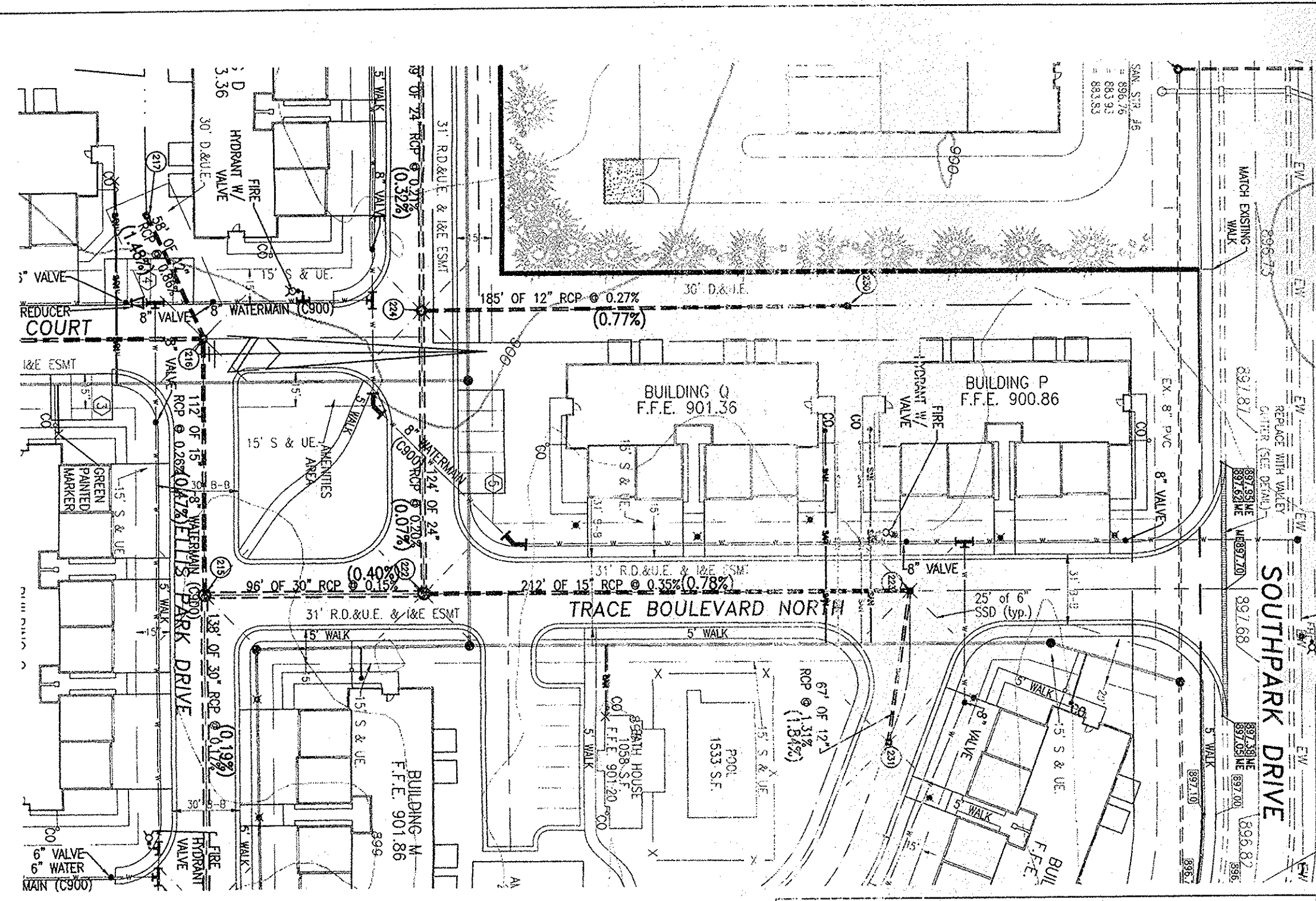

- LEGEND**
- RIGHT-OF-WAY LINE
  - STORM SEWER LINE
  - SWALE
  - SANITARY SEWER LINE
  - SANITARY SEWER MANHOLE
  - SANITARY SEWER LATERAL
  - FLOW DIRECTION
  - EXISTING SPOT ELEVATION
  - EXISTING CONTOURS
  - PROPOSED ELEVATION
  - STORM MANHOLE
  - STORM INLET
  - TOP OF CASTING
  - INVERT
  - REINFORCED CONCRETE PIPE
  - MANHOLE
  - M.H.
  - STR.
  - D. & U.E.
  - S.D. & U.E.
  - S & U.E.
  - SAN
  - H.C.P.
  - M.E.
  - S.S.P.
  - TYP.
  - PROP.
  - EX.
  - R.
  - I & E ESMT
  - SANITARY SEWER
  - MATCH EXISTING GRADE
  - SUBSURFACE DRAIN AND SUMP LINE
  - STORM SEWER
  - GRANULAR BACKFILL
  - CONCRETE END SECTION
  - SUBSURFACE DRAIN
  - SANITARY SEWER PIPE (SDR-35)
  - TYPICAL
  - EXISTING
  - RADIUS
  - INGRESS/EGRESS EASEMENT

**NOTE:**

1. STORM SEWERS MUST MEET HAMILTON COUNTY SURVEYORS OFFICE CURRENT DETAILS AND SPECIFICATIONS.
2. ALL CASTINGS MUST BE STAMPED WITH "DUMP NO WASTE DRAINS TO WATERWAY"

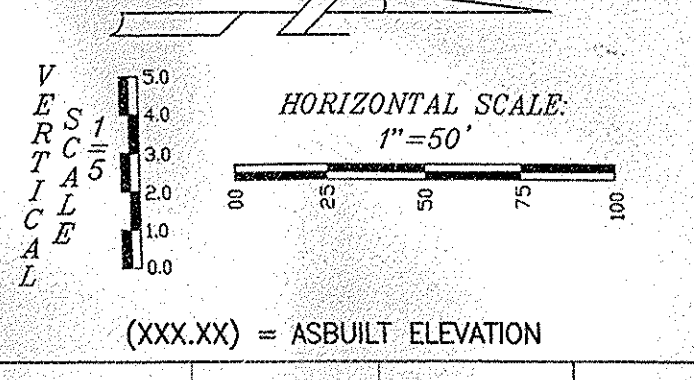
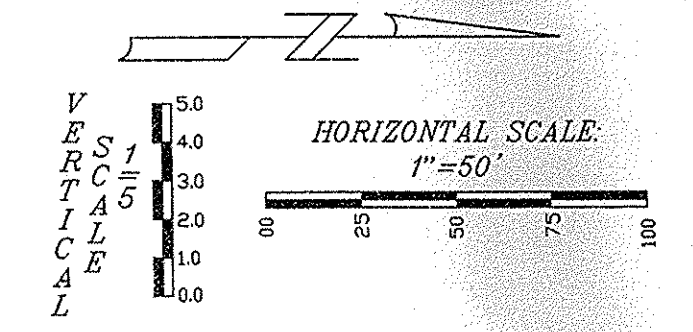
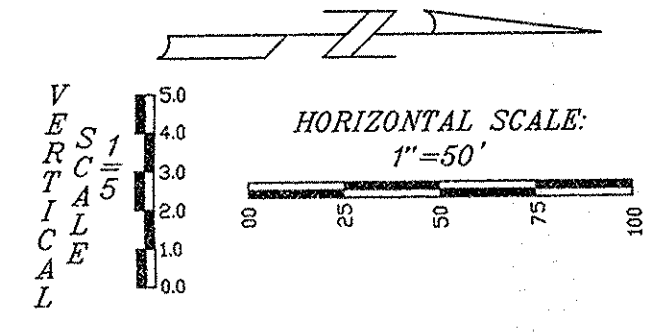

**RECORD DRAWING**  
 STORM SEWER AS-BUILTS  
 STORM SEWER STRUCTURES ONLY  
 12-09-05

*James K. Shinneman*  
 JAMES K. SHINNEMAN P.E. 10200392

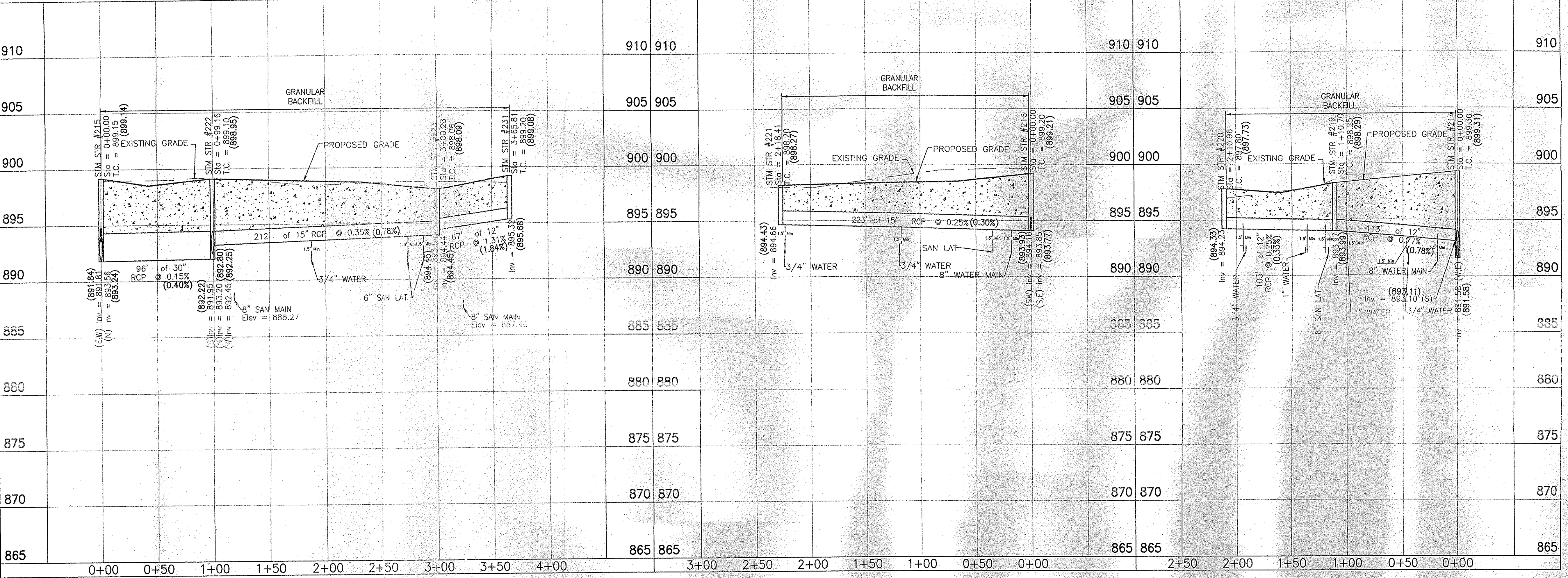

**WEIHE ENGINEERS, INC.**  
 10505 NORTH COLLEGE AVENUE  
 INDIANAPOLIS, INDIANA 46280  
 (317) 846-6611 FAX: (317) 843-0546  
 TOLL-FREE (800) 452-4408

ALLAN H. WEIHE  
 REGISTERED CIVIL ENGINEER  
 REGISTERED LAND SURVEYOR  
 PRESIDENT

CIVIL ENGINEERS • LAND SURVEYORS • LAND PLANNERS • LANDSCAPE ARCHITECTS

PROJECT NO.	W04-0531
DATE	10/13/04
DESIGNED BY	JAS
CHECKED BY	JAS
DRAWN BY	JAS
DATE	10/13/04

REVISIONS AND ISSUES	DATE	BY
REVISIONS FOR RESUBMITAL FOR REVIEW	1/10/04	JAS
REVISIONS FOR RESUBMITAL FOR REVIEW	1/14/04	JAS
REVISIONS TO GRADING AND LANDSCAPE PER HAMILTON COUNTY SURVEYORS OFFICE	12/08/04	JAS
REVISIONS TO GRADING	1/20/05	JAS
REVISIONS TO WATER MAIN	4/27/05	JAS
STORM, SANITARY AND WATER AS-BUILTS	12/09/05	JAS

**JAMES K. SHINNEMAN**  
 REGISTERED  
 NO. 10200392  
 STATE OF INDIANA  
 PROFESSIONAL ENGINEER

*James K. Shinneman*  
 JAMES K. SHINNEMAN P.E. 10200392

This information was gathered for input into the Hamilton County Geographic Information System (GIS). This document is considered an official record of the GIS.  
 Entry Date: March 2009  
 Entered By: SLM

PREPARED FOR:  
**Kensington Carriage Homes at Oak Trace**  
 C & R CUSTOM HOMES

**STORM SEWER PLAN AND PROFILE**  
 Part of the INV 1/4 of Section 16, Township 18 North, Range 3 East, Meridian 11, near Oak Trace, Hamilton County, IN.

SHEET NO. **8**

PROJECT NO.  
 W04-0531

LOCATION: R:\Projects\W04-0531\Drawings\CONSET\W040531SU.dwg  
 DATE/TIME: December 06, 2005 - 10:10am  
 PLOTTED BY: csm

**NOTE:**

1. STORM SEWERS MUST MEET HAMILTON COUNTY SURVEYORS OFFICE CURRENT DETAILS AND SPECIFICATIONS.
2. ALL CASTINGS MUST BE STAMPED WITH "DUMP NO WASTE DRAINS TO WATERWAY"

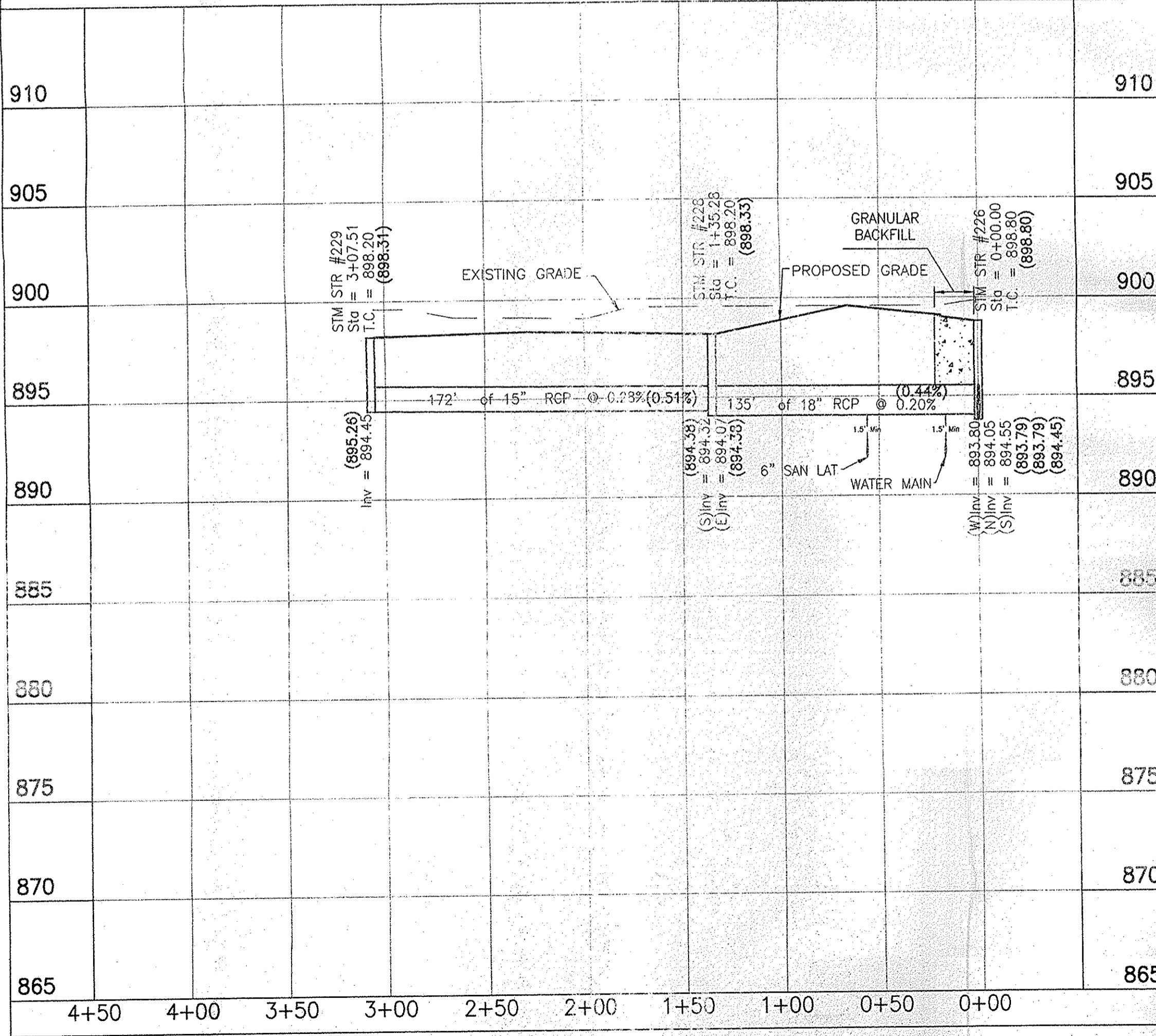
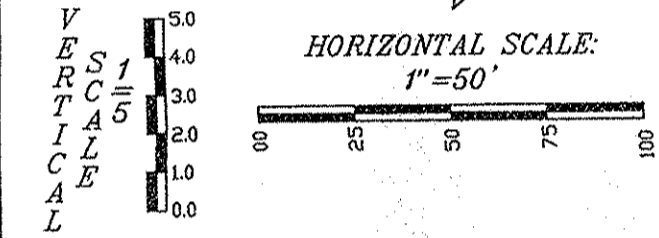
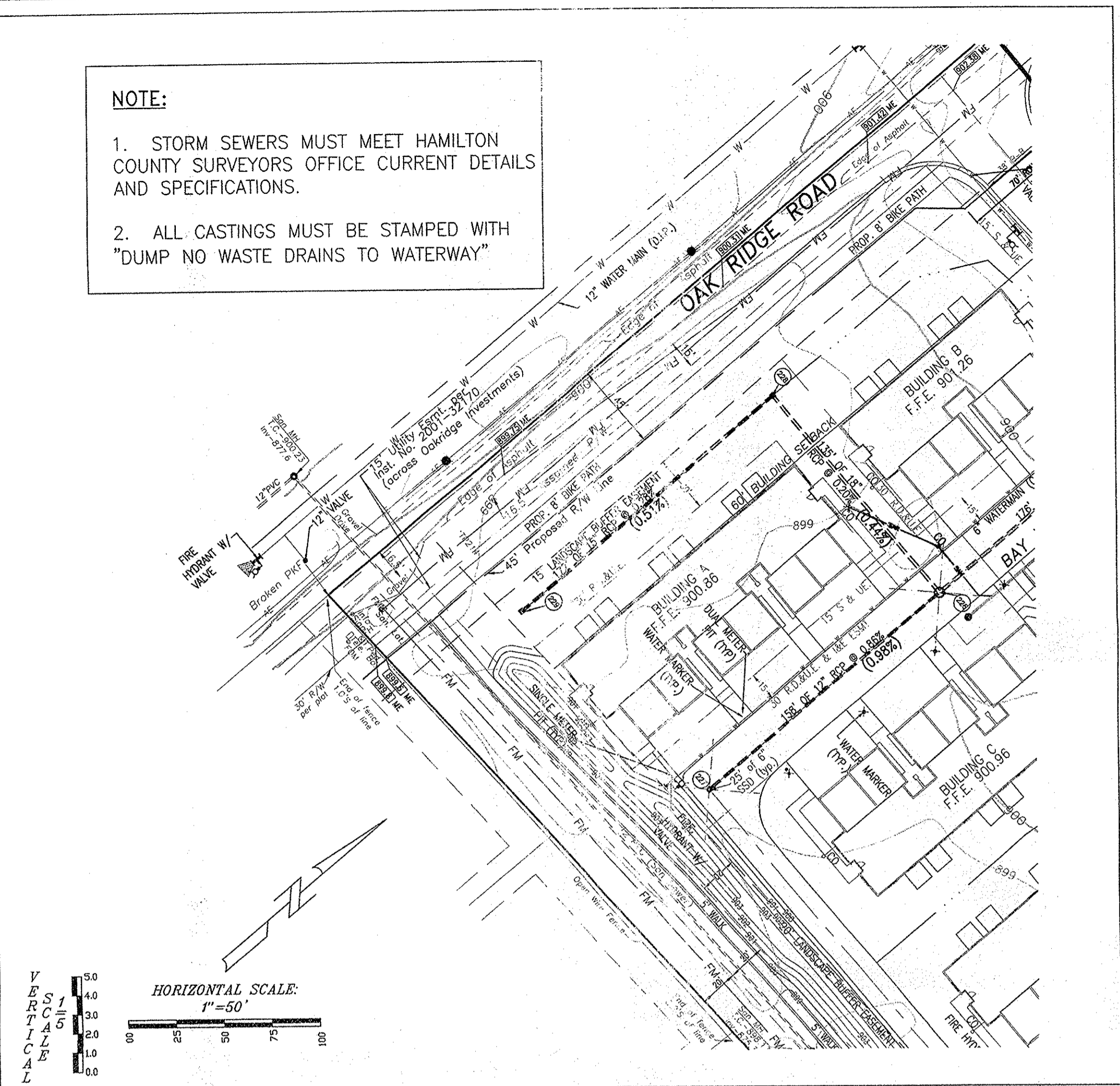

- LEGEND**
- RIGHT-OF-WAY LINE
  - STORM SEWER LINE
  - SWALE
  - SANITARY SEWER LINE
  - SANITARY SEWER MANHOLE
  - SANITARY SEWER LATERAL
  - FLOW DIRECTION
  - EXISTING SPOT ELEVATION
  - EXISTING CONTOURS
  - PROPOSED ELEVATION
  - STORM MANHOLE
  - STORM INLET
  - TOP OF CASTING
  - INVERT
  - REINFORCED CONCRETE PIPE
  - M.H.
  - STR.
  - D. & U.E.
  - S.D. & U.E.
  - S & U.E.
  - SAN
  - H.C.
  - M.E.
  - STM
  - R
  - I & E ESMT

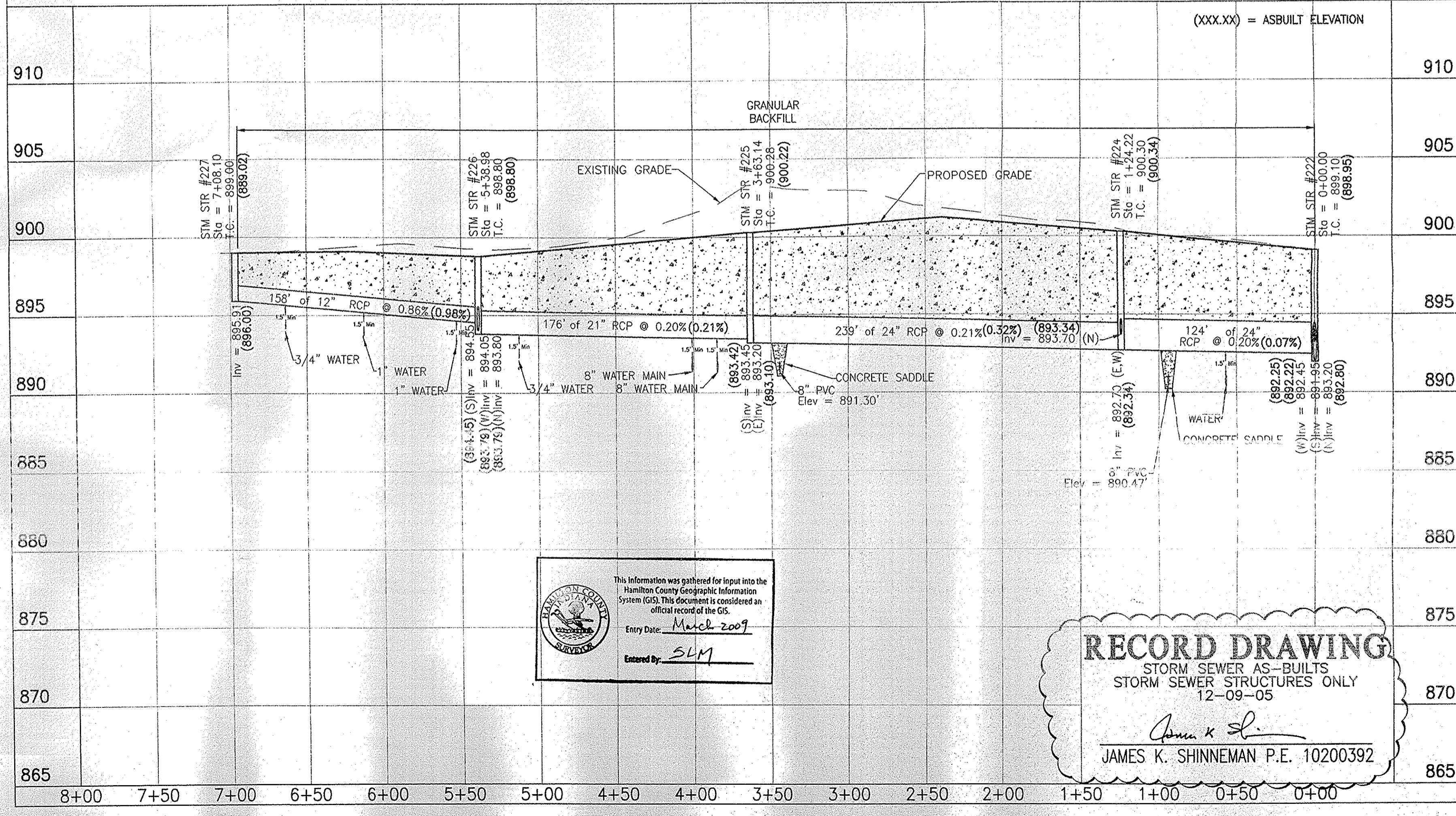
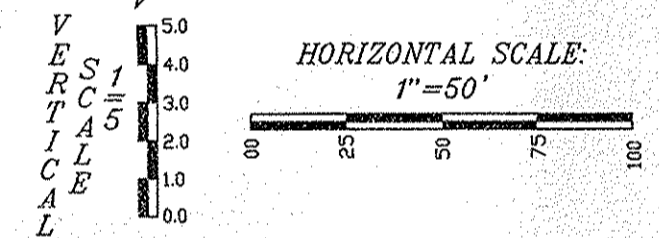
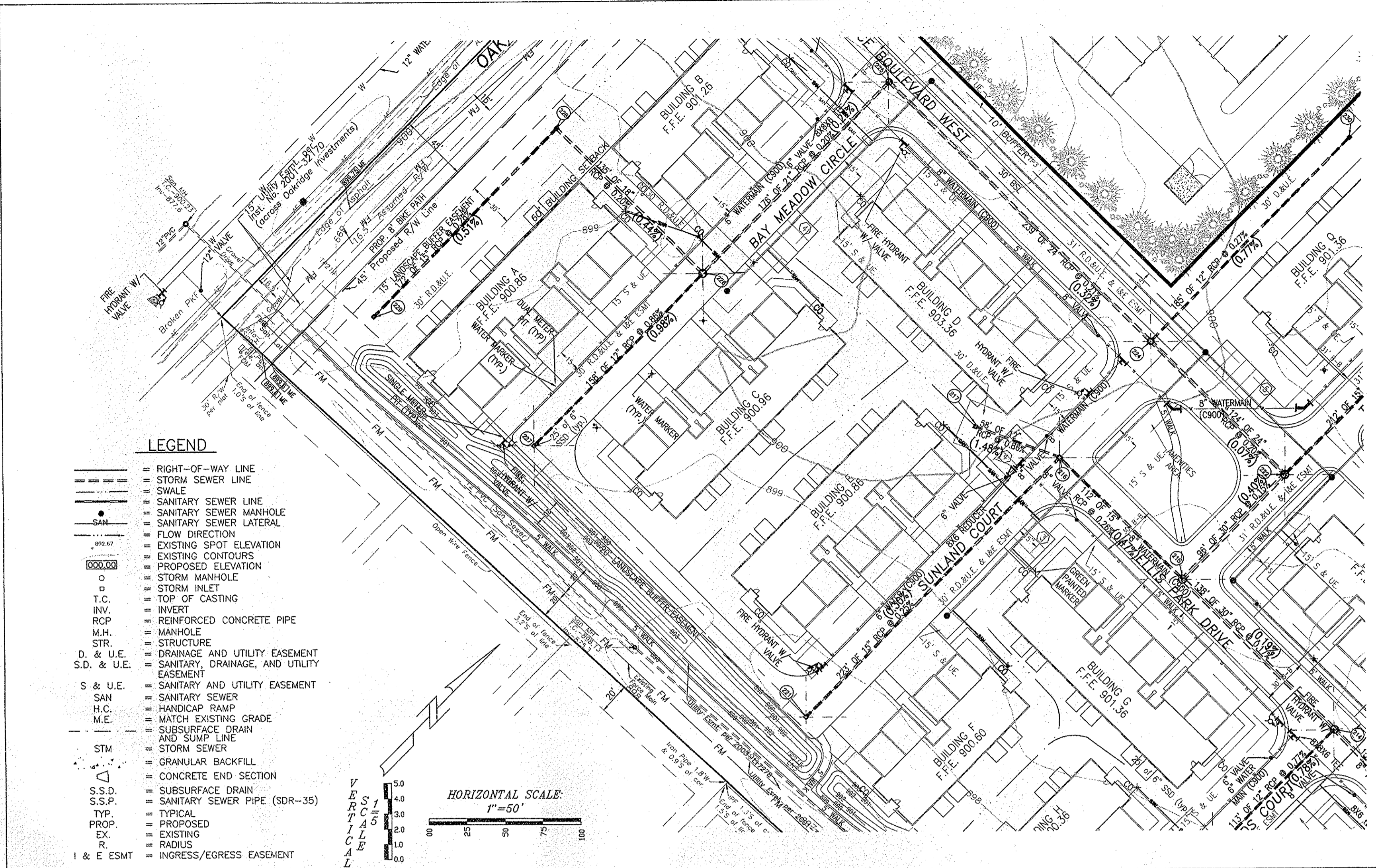

This information was gathered for input into the Hamilton County Geographic Information System (GIS). This document is considered an official record of the GIS.  
 Entry Date: March 2009  
 Entered By: SLM

**RECORD DRAWING**  
 STORM SEWER AS-BUILTS  
 STORM SEWER STRUCTURES ONLY  
 12-09-05  
 James K. Shinnehan  
 JAMES K. SHINNEHAN P.E. 10200392

**WEIHE ENGINEERS, INC.**  
 10505 NORTH COLLEGE AVENUE  
 INDIANAPOLIS, INDIANA 46280  
 (317) 846-6611 FAX: (317) 843-0546  
 TOLL-FREE (800) 452-6408

ALLAN H. WEIHER  
 REGISTERED CIVIL ENGINEER  
 REGISTERED LAND PRESIDENT  
 CIVIL ENGINEERS • LAND SURVEYORS • LAND PLANNERS • LANDSCAPE ARCHITECTS

PRODUCT NO.: W04-0531  
 DATE: 11/20/04  
 DESIGNED BY: JWS  
 DRAWN BY: JWS  
 CHECKED BY: JWS  
 DATE: 10/13/04

REVISIONS AND ISSUES:  
 1. REVISION FOR HAMILTON COUNTY SURVEYORS OFFICE PER  
 2. REVISION FOR HAMILTON COUNTY SURVEYORS OFFICE PER  
 3. REVISION FOR HAMILTON COUNTY SURVEYORS OFFICE PER

JAMES K. SHINNEHAN  
 REGISTERED  
 NO. 10200392  
 STATE OF INDIANA  
 PROFESSIONAL ENGINEER  
 James K. Shinnehan 12/19/05  
 JAMES K. SHINNEHAN P.E. 10200392

PREPARED FOR:  
**Kensington Carriage Homes at Oak Trace**  
 C & R CUSTOM HOMES  
 STORM SEWER PLAN AND PROFILE  
 Part of the 100' 1/4" of Station 12, Township 10 North, Range 3 East, Meridian 12 West, Hamilton County, Indiana, 46280

SHEET NO. **9**  
 PROJECT NO. W04-0531

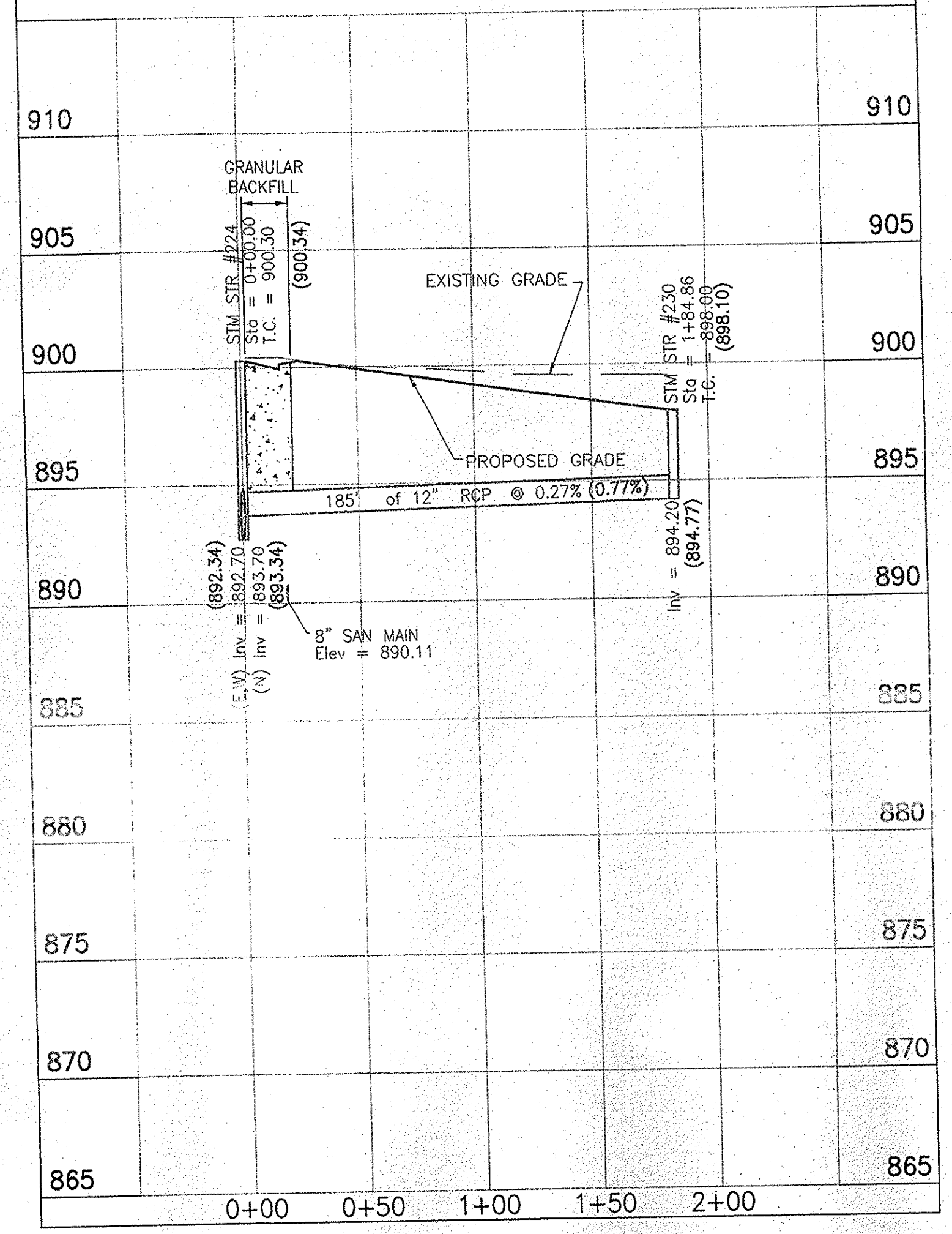
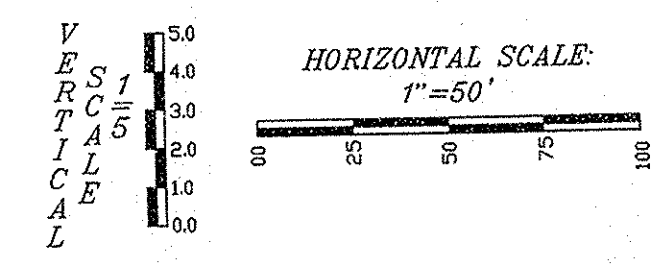
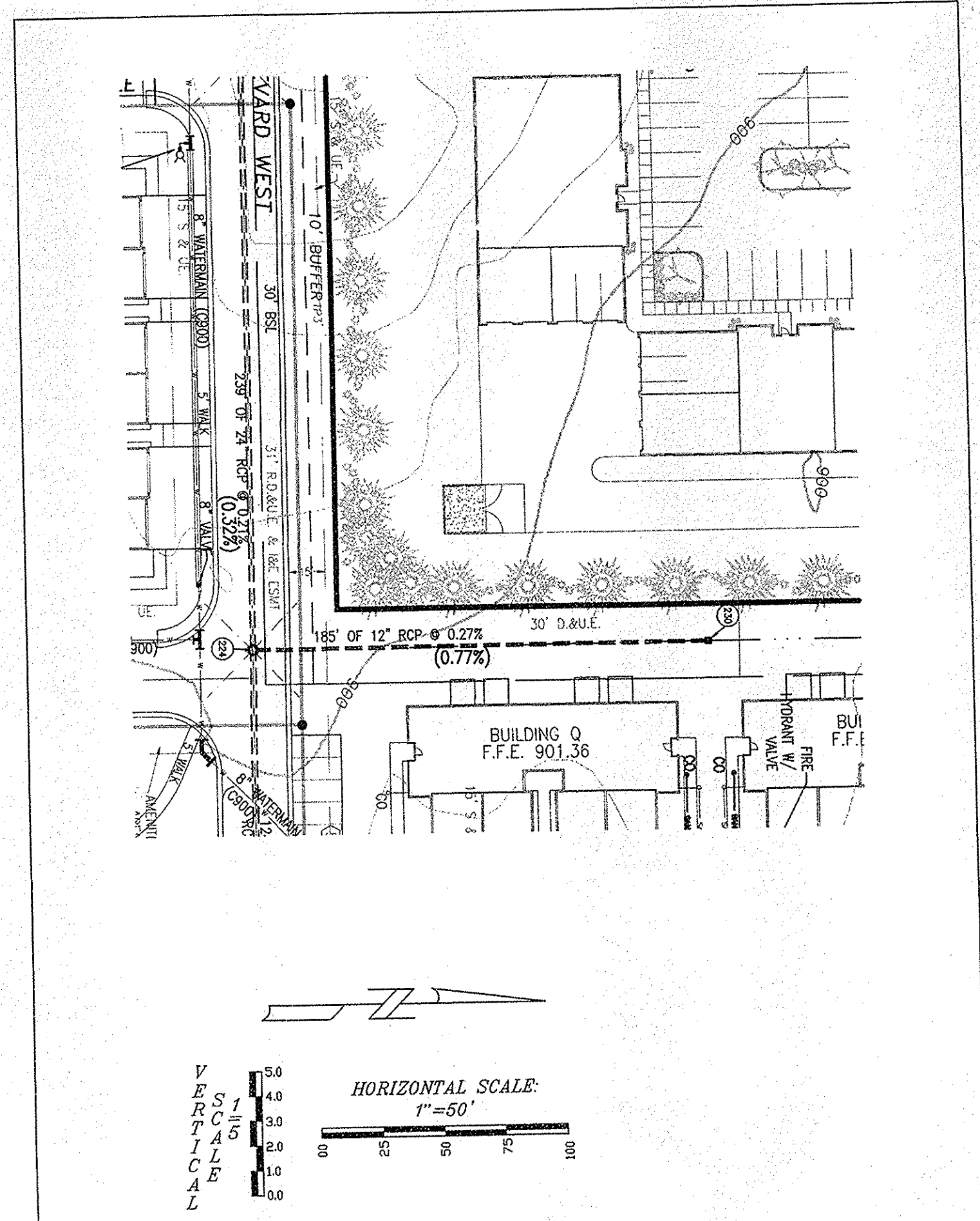

- LEGEND**
- RIGHT-OF-WAY LINE
  - STORM SEWER LINE
  - SWALE
  - SANITARY SEWER LINE
  - SANITARY SEWER MANHOLE
  - SANITARY SEWER LATERAL
  - FLOW DIRECTION
  - EXISTING SPOT ELEVATION
  - EXISTING CONTOURS
  - PROPOSED ELEVATION
  - STORM MANHOLE
  - STORM INLET
  - T.C.
  - INVERT
  - REINFORCED CONCRETE PIPE
  - MANHOLE
  - STRUCTURE
  - DRAINAGE AND UTILITY EASEMENT
  - SANITARY, DRAINAGE, AND UTILITY EASEMENT
  - SANITARY AND UTILITY EASEMENT
  - SANITARY SEWER
  - HANDICAP RAMP
  - MATCH EXISTING GRADE
  - SUBSURFACE DRAIN AND SUMP LINE
  - STORM SEWER
  - GRANULAR BACKFILL
  - CONCRETE END SECTION
  - SUBSURFACE DRAIN
  - SANITARY SEWER PIPE (SUR-35)
  - TYP.
  - PROP.
  - EX.
  - R.
  - INGRESS/EGRESS EASEMENT
- (XXX.XX) = ASBUILT ELEVATION

**NOTE:**

1. STORM SEWERS MUST MEET HAMILTON COUNTY SURVEYORS OFFICE CURRENT DETAILS AND SPECIFICATIONS.
2. ALL CASTINGS MUST BE STAMPED WITH "DUMP NO WASTE DRAINS TO WATERWAY"

**RECORD DRAWING**  
 STORM SEWER AS-BUILTS  
 STORM SEWER STRUCTURES ONLY  
 12-09-05

*James K. Shinneman*  
 JAMES K. SHINNEMAN P.E. 10200392

This information was gathered for input into the Hamilton County Geographic Information System (GIS). This document is considered an official record of the GIS.

Entry Date: March 2009  
 Entered By: SLM

**WEIHE ENGINEERS, INC.**

ALLAN H. WEIHE  
 REGISTERED CIVIL ENGINEER  
 REGISTERED LAND SURVEYOR  
 PRESIDENT

10305 NORTH COLLEGE AVENUE  
 NORTH ANDREWS INDIANA 46280  
 (317) 846-6611 FAX: (317) 843-0546  
 TOLL-FREE: (800) 452-6408

CIVIL ENGINEERS • LAND SURVEYORS • LAND PLANNERS • LANDSCAPE ARCHITECTS

PROJECT NO.:	W04-0531
DWG. NO.:	SS-01
DATE:	12/08/04
DESIGNED BY:	JAB
DRAWN BY:	JAB
CHECKED BY:	JAB
DATE:	10/13/04

REVISIONS AND REVISIONS  
 REVISIONS TO W04-0531  
 REVISIONS TO SS-01  
 REVISIONS TO SS-02  
 REVISIONS TO SS-03  
 REVISIONS TO SS-04  
 REVISIONS TO SS-05  
 REVISIONS TO SS-06  
 REVISIONS TO SS-07  
 REVISIONS TO SS-08  
 REVISIONS TO SS-09  
 REVISIONS TO SS-10  
 REVISIONS TO SS-11  
 REVISIONS TO SS-12  
 REVISIONS TO SS-13  
 REVISIONS TO SS-14  
 REVISIONS TO SS-15  
 REVISIONS TO SS-16  
 REVISIONS TO SS-17  
 REVISIONS TO SS-18  
 REVISIONS TO SS-19  
 REVISIONS TO SS-20

JAMES K. SHINNEMAN P.E. 10200392

PREPARED FOR  
**Kensington Carriage Homes at Oak Trace**  
 C & R CUSTOM HOMES

STORM SEWER PLAN AND PROFILE  
 Part of the 1/4 of Section 12, Township 18 North, Range 2 East, Jennings Township, Hamilton County, Indiana

SHEET NO.  
**10**  
 PROJECT NO.  
 W04-0531

LOCATED IN: C:\P\W04-0531\W04-0531-SS-01.dwg  
 LAYOUT: STORM (1/4) (1)  
 DATE: 12/08/04  
 TIME: 10:00 AM